

# - 11 - SPARE PARTS

## 11.1 WARNING FOR THE CUSTOMER

Before ordering any particular spare part, it is always necessary to specify the serial number of the machine to which the part shall fit.

## 11.2 DETAILED DRAWING OF MACHINE CODE 109.0001 SEP4/1 STRIP/CONNECTOR SEPARATOR MACHINE 110V

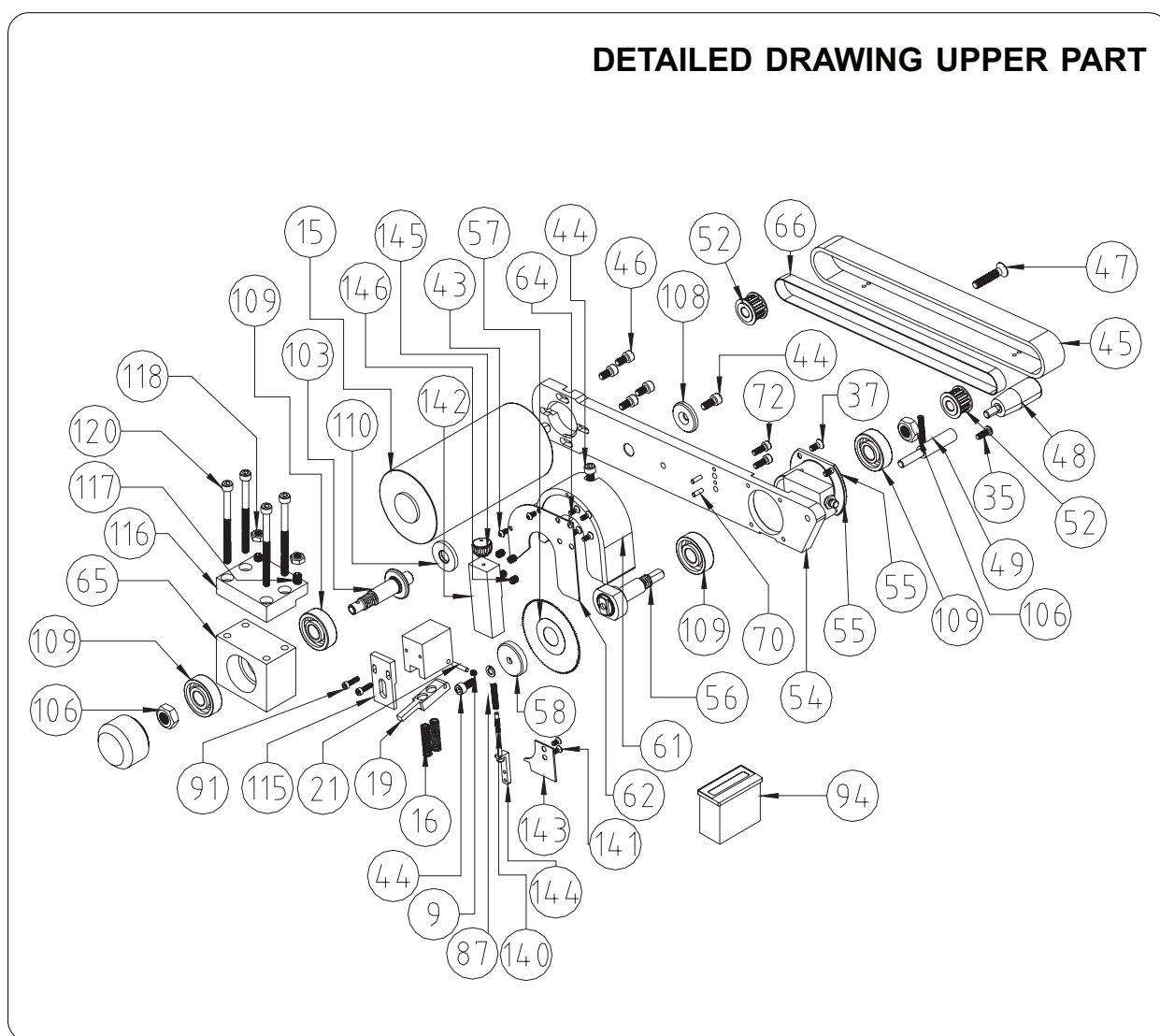

# DETAILED DRAWING LOWER PART

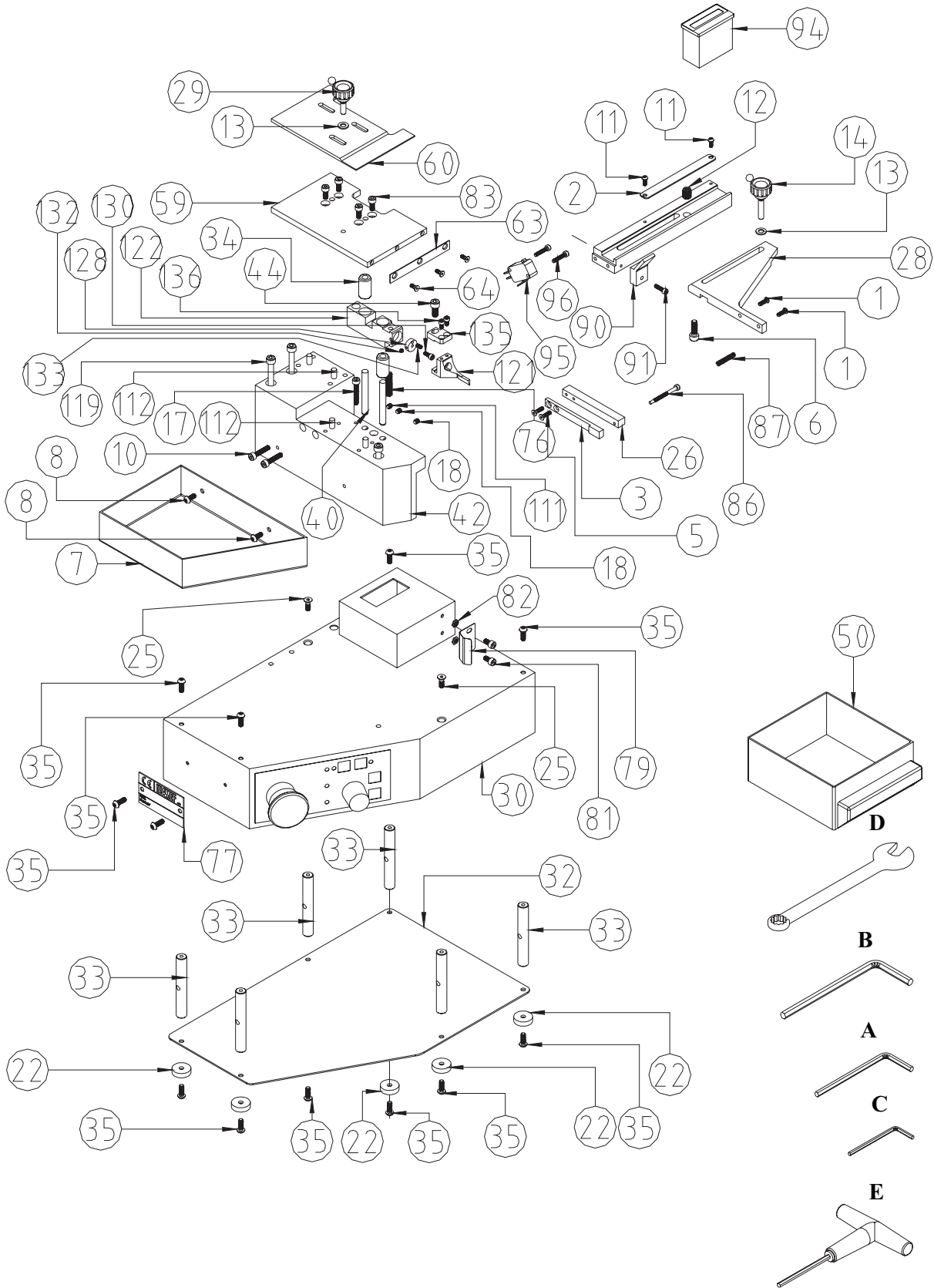

## 11.2.1 READING KEY FOR DETAILED DRAWING OF MACHINE CODE 109.0001 SEP4/1 STRIP/CONNECTOR SEPARATOR MACHINE 110V

Pos.	Code	Description	Q.ty
1	400341	SCREW TCEI M3X10	2
2	1090026	PITCH 2.54 REFERENCE PLATE FOR SEP4	1
3	1090025	CONNECTOR POSITIONING FLAP FOR SEP4	1
5	300205	CS SCREW M3X12	2
6	500055INOX	SCREW TCEI M5X16 INOX	1
7	1090027	BIN FOR COMPONENTES TO BE CUT	1
8	400114INOX	SCREW TBEI M4X8 INOX	2
9	500018	SCREW PP M4X4 UNBRAKO	1
10	930075	SCREW TCEI M4X20	2
11	750503/U	VITE TBEI M3X6 UNBRAKO	2
12	400211	ENSAT BUSHING M5/M8X10	1
13	740137INOX	WASHER Ø 5 /OUT 15 BLACK STEEL	2
14	950306	KNOB M5X25 BT.20 p-M5X25	1
15	1090030	DC DIRECT MOTOR Ø63 24 V	1
16	760171	COMPRESSION SPRING 0,8X6,3 H=33	2
17	210136	SCREW TCEI M4X25	1
18	850510	CP SET SCREW M4X6	2
19	1090021	COMPONENT BODY HOLDER BELT TENSION ADJUSTER	1
21	850417	PARALLEL PIN D.3X16	1
22	150106	RUBBER FOOT D.18	4
23	740153	THREADED TUBULAR RIVET M5	3
25	770028	CS SCREW M4X12	2
26	1090024	CONNECTOR POSITIONING FLAP SUPPORT SEP4	1
27	1090022	ADJUSTER SUPPORT SEP4	1
28	1090023	CONNECTOR POSITIONING FLAP ADJUSTER SEP4	1
29	400210	KNOB M5X16	1
30	1090001	COMPLETE DRIVE CONTROL FOR SEP4	1
31		ELASTIC WASHER - DIN 128 - A5	1
32	1000101	MOTOR SYSTEM SUBSTITUTION COVER	1
33	740204	SPACER FOR MOTOR CONNECTION	6
34	120256	INA Ø 12 Ø6 L.22 BEARING TP/TO-CF	2
35	400114INOX	SCREW TBEI M4X8 STEEL	4
35/a	600050INOX	SCREW TBEI M4X6 STEEL	2
37	850108	SCREW TSEI M4X10	4
39	1090020	BELT TENSION ADJUSTER SUPPORT SEP4	1
40	120257	PARALLEL PIN FOR COMPONENT BODY ADJUST. Ø6X50 TP/TO-CF	2
42	1090002	MACHINE SUPPORT SEP4	1
43	750503	SCREW TBEI M3X6	3
44	780008	CAP SCREW M5X12	3
45	1090013	200XL 037 BELT COVER	1
46	850304	SCREW TCEI M5X10	4

Pos.	Code	Description	Q.ty
47	800608	CS SCREW M6X30	1
48	940003	HANDLE FOR SMA	1
49	1090016	SPACER SEP4	1
50	400801	PART BIN	1
52	500010	COMPLETE PULLEY Z11	2
54	1090004	LEVER SEP4	1
55	1090008	BEARING SUPPORT FOR FIXING SHAFT	1
56	1090009	FIXING SHAFT FOR CUTTING BLADE SEP4	1
57	1090011	CUTTING BLADE Ø63 EST. SP.0,25 Ø16 INT. Z100 SEP4	1
58	1090012	CUTTING BLADE LOCKING DISC SEP4	1
59	1090003	COMPONENT POSITIONING PLATE SEP4	1
60	1090017	MOVABLE GUIDE FOR COMPONENT CONTROL SEP4	1
61	1090014	SAFETY COVER SEP4	1
62	1090015	SAFETY SHEET SEP4	1
63	1090018	STATIONARY GUIDE FOR COMPONENT CONTROL SEP4	1
64	500006	CS SCREW M3X8	1
65	1090006	BEARING HOLDER FOR LEVER FIXING SHAFT SEP4	1
66	1090007	SYBCHRONOUS BELT 200 XL 037 DIN ISO 5296-1	1
70	500024	PARALLEL PIN M3X10	2
72	750107	SCREW TCEI M4X12	2
76	27.0110	COMPRESSION SPRING 0,63x6,3x36,5	1
77	200102	MACHINE NUMBER PLATE	1
79	1090031	BIN HOLDER BRACKET SEP4	1
81	500023	CAPSCREW M4X8	2
82	750108	NUT M4	2
83	400117	SCREW TCEI M4X10	4
86	760140UK	SCREW TCEI M3x35	1
87	850416	SPRING D11240 D.4.5 H=X30 FOR INSERT HOL	1
90	1090029	FLAP SEP4	1
91	400512	CAPSCREW M3X12	3
94	1090034	IMPULSES COUNTER	1
95	750115	MICRO SCWITCH AH-71823 FOR	1
96	750116	CAPSCREW M3X16	2
103	1090005	LEVER FIXING SHAFT SEP4	1
106	780004INOX	HEXAGONAL NUT- DIN 555-5 - M10	2
108	750256	WASHER FOR GEAR/CUTT.WHEEL/ TRANS. PULLEY	1
109	740142	BEARING 7201 BTVP FOR CUTTING HOLDERS	4
110	1090035	CUTTING BLADE TRIMMING SPACER SEP4	1
111	500011	SCREW PP M4X5	1
112	850218	SPINA CIL. D. 5X20	4
115	1090037	BELT TENSION ADJUSTER STOP	1
116	1090038	LEVER STOP ADJUSTER	1

Pos.	Code	Description	Q.ty
117	740155	CP SET SCREW PP M6x20	2
118	600030INOX	NUT M6 STEEL	2
119	160046	SCREW TCEI M5x50	3
120	VITC0570	SCREW TCEI M5X70	7
121	1090041	COMPONENT BODY STOP FOR SEP4	1
122	1090042	COMPONENT BODY STOP HOLDER FOR SEP4	1
127	1090045	SMALL SAFETY COVER FOR BEARING	1
128	1090044	REGISTER FOR COMPONENT STOP ADJUSTMENT	1
130	340112	SCREW TCEI M3X8 UNBRAKO	1
132	850415	SCREW PP M3X4	1
133	210124	SCREW PP M3X6 UNBRAKO	1
135	1090043	SUPPORT FOR COMPONENT BODY STOP	1
136	590006INOX	VSCREW TCEI M3x6 INOX	2
137	1090045	SMALL SAFETY COVER FOR BEARING	1
138	1090046	START /STOP PUSH-BUTTON SUPPORT	1
139		START /STOP PUSH-BUTTON	1
<b>140</b>		<b>VITE A TESTA CILINDRICA - M3X40</b>	<b>1</b>
<b>141</b>		<b>VITE SVASATA - UNI 5933 - M3 X 6</b>	<b>2</b>
<b>142</b>	<b>1090048</b>	<b>SUPORTO PROTEZIONE LAMA</b>	<b>1</b>
<b>143</b>	<b>1090049</b>	<b>PROTEZIONE LAMA</b>	<b>1</b>
<b>144</b>	<b>1090050</b>	<b>ASTA DI SCORRIMENTO</b>	<b>1</b>
<b>145</b>	<b>780517</b>	<b>POMELLO FC M3</b>	<b>1</b>
<b>146</b>	<b>120120</b>	<b>BOCCOLA MUBUX M3-M5-H6 SERIE 970</b>	<b>5</b>

#### ADJUSTMENT TOOLSET

A	350308	SPANNER E 2,5	1
B	500062	KEY FOR FEEDERS E4	1
C	1090040	ALLEN KEY 22mm	1
D	1090039	ALLEN KEY E 2	1
E	400804	ALLEN KEY mm. 3	1

#### OTHER VERSIONS

109.0002 SEP4/2 STRIP/CONNECTOR SEPARATOR MACHINE 220V